

COB Strip Series 528D LED Strip

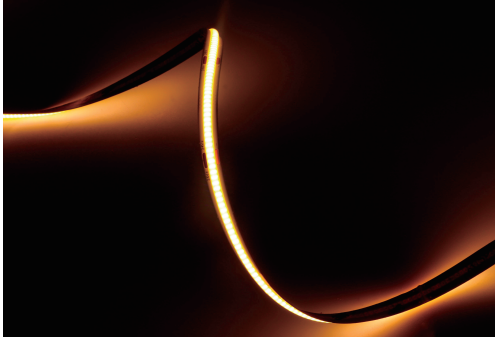

- 528 flip-chip LEDs in linear array, monolithically encapsulated, hotspot-free with uniform chromaticity
- High-thermal-conductivity FPCB design, flexible for effortless bending and installation
- LED chips directly mounted on FPCB, 170° wide viewing angle
- DC24V Constant Voltage, SELV, Low Voltage Drop, Standard Cascading 5m
- 24VDC constant voltage operation, SELV compliant, low voltage drop, supports 5m daisy-chaining
- Back-mounted high-tack thermal adhesive tape for secure and durable installation
- RoHS-compliant LED light source with high energy efficiency

Technologies

- ON/OFF

General Application

- This product is suitable for home decoration: engineering projects, large buildings, hotels, shopping malls, indirect lighting, recessed lighting, decorative lighting and other applications.

Color Options

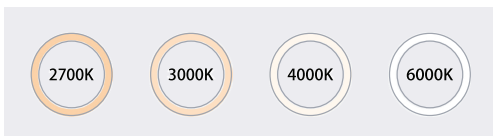

Dimension

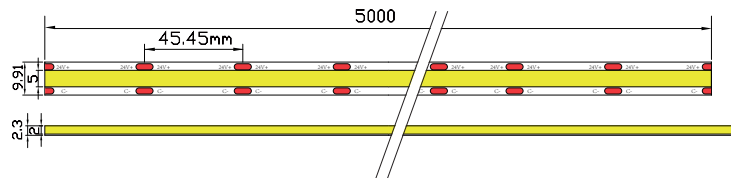

Beam Angle

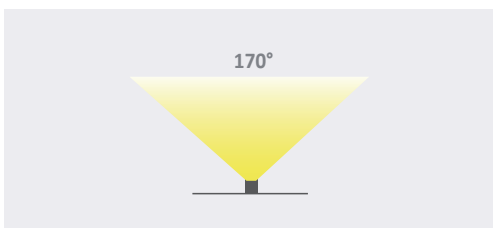

Product Specifications

P/N	LED Quantity	CCT k	CRI	LED (SM)	LUMENS (lm/m)	VIN (v)	Current (mA/M)	Power (W/M)	Cut Length (MM)	Max Run (M)
RL-FV2410528COB14-927	528	2600-2800	90	COB	1260	24	583	14	45.45	5
RL-FV2410528COB14-930	528	2800-3200	90	COB	1260	24	583	14	45.45	5
RL-FV2410528COB14-940	528	3850-4250	90	COB	1260	24	583	14	45.45	5
RL-FV2410528COB14-960	528	6100-6600	90	COB	1260	24	583	14	45.45	5

Other Specifications

Protection grade	IP20
Working temperature(°c)	-25~+40
Storage environment temperature (°c)	-25~+70
Standard length	5
Maximum cascade length(m)	5
weight	/

Remark

- The test environment temperature is 25±2°C;
- The above data are typical values, the actual parameters of the product may be different from the typical data; the data is subject to change without notice;
- The above "/" means that this parameter is not required for the time being.

Applied Standards



Installation

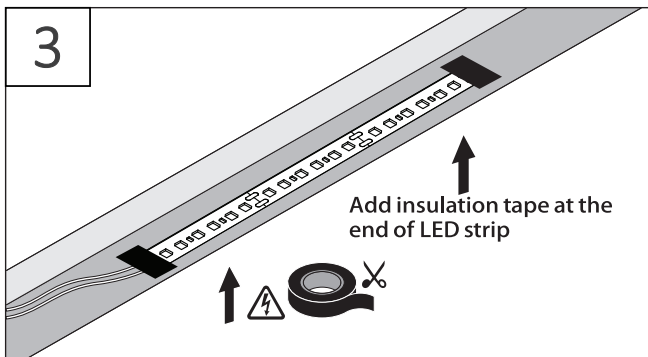
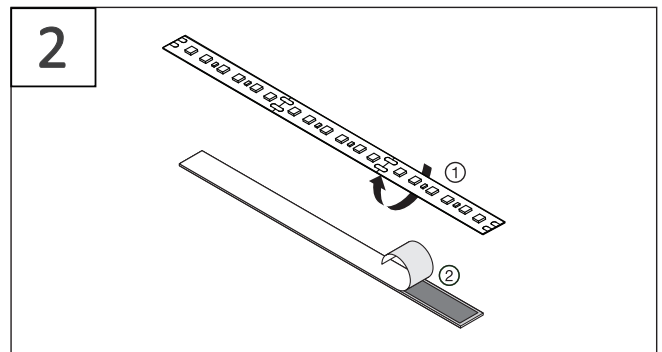
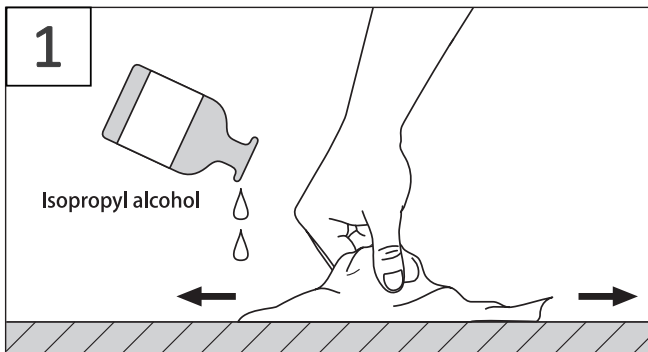

Do's and Don'ts

Minimum Bending Radius

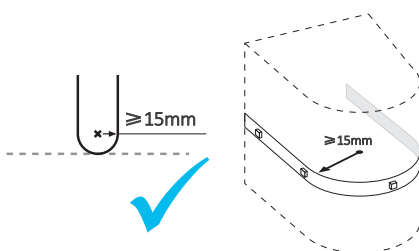

Do Not Twist

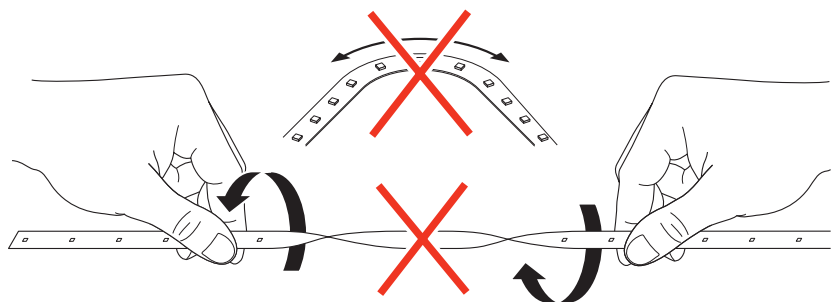

Note: During bending operations, please follow the standard operations in the above diagram. Excessively small bending angles or non-standard operations will cause adverse effects to the product's internals.

Schematic diagram of electrical connection

Monochrome temperature wiring diagram 1: Power + lamp belt connection mode

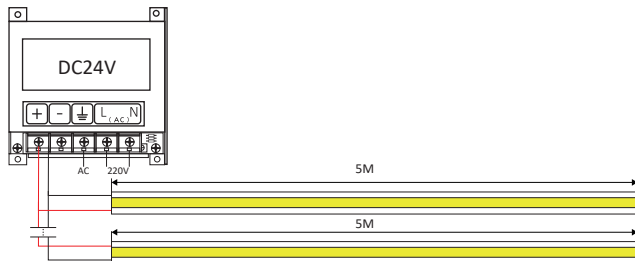

Package

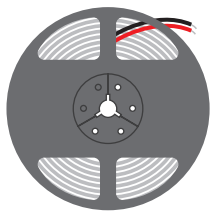

Reel



Electrostatic bag

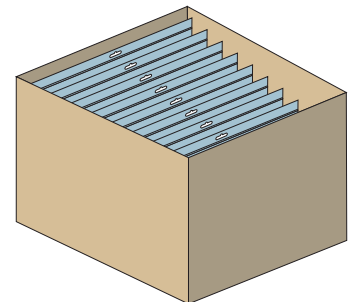

Carton



Packing completed

Quantity per roll (m)	Quantity per case (m)	Total weight (Kg)	Outer box dimensions (mm)		
			Length	Width	Height
5	800	≤ 20	480	430	370

Note :The above-mentioned packaging quantity and weight are only for the packaging method shown in the figure. There will be differences in the number and weight of packaging for other packaging methods, and the actual product shall prevail.

Common product faults and their troubleshooting methods

Fault Phenomena	Possible Causes	Troubleshooting Methods
All lights off	1.Mains power failure	Power on
	2.Open circuit or short circuit at switching power supply output triggering auto-protection	Troubleshoot and restore power
	3.Reverse polarity at LED strip power input	Check wire connection status to ensure correct polarity
Partial lights off	1.Partial switching power supply failure	Inspect power supply system and resolve faults
	2.Wiring error in partial LED strip circuits	
	3.Reverse polarity in partial LED strips	Correct wiring
LED uneven brightness or insufficient brightness	1.Power supply overload	Replace with higher-power supply according to load
	2.Excessive line loss in switching power circuits or significant line loss discrepancies	Maintain LED strip operating voltage within $\pm 5\%$ of rated voltage 1.Shorten power cable length between power supply and LED strip or use larger gauge wires; 2.Ensure number of LED strips per circuit \leq max allowed cascading quantity and keep cascading quantities similar per circuit).
	3.Excessive serial connection of LED strips	Adjust LED strip quantity per power branch to meet max allowed cascading requirements per circuit
LED flickering	1.Poor contact at connection points	Identify and resolve poor contact points
	2.Switching power supply malfunction	Replace switching power supply

Notice

- If the external flexible cable of this product is damaged, the cable must be replaced by the manufacturer or similarly qualified personnel to prevent hazards.
- For specific installation arrangements and precautions, refer to the product user manual.
- Data in this specification is based on standard products, Actual delivered products may vary, subject to physical measurements
- All product diagrams in this specification are schematic diagrams, Actual delivered products may differ, subject to physical objects
- Technical modifications may be implemented without prior notice.
- Shenzhen Meishang Lighting Co., Ltd. reserves the final interpretation rights of this manual.



Specialized
LED Strip Manufacturer

Shenzhen
Relight Technology Co.,Ltd

6th Floor, Building A, Guancheng IndustrialPark,Gongming Town,
Guangming District, Shenzhen, China

Tel: 86 0755 3369 1713
Web: www.relight-tech.com
E-mail: Sales@relight-tech.com